

World's Leading Manufacturer Of Fibreglass Whip Antennas



SPECIALISTS FOR HIGH FREQUENCY

VTGS-20BH Steel Tower

THE VTGS-20BH SERIES OF STEEL TOWERS PROVIDES A VERY CONVENIENT METHOD OF INSTALLING AND ERECTING VALCOM'S V132, V147, V330 AND V425 SERIES ANTENNAS. THEY ARE INTENDED FOR USE WITH THE VGP-10 GIN POLE AVAILABLE SEPARATELY. IN ADDITION TO EASING ANTENNA INSTALLATION, THESE TOWERS ARE USED TO ACHIEVE GROUND CLEARANCE TO AVOID SNOW BUILD-UP AS WELL AS TO PROVIDE A MEANS OF MOUNTING AUXILIARY EQUIPMENT. THE FOUR FOOT VERSION STEEL TOWER IS SHOWN IN THE PHOTOGRAPH.

FEATURES:

- RUGGED GALVANIZED STEEL CONSTRUCTION
- HINGED BASE SECURES WITH LOCKING PIN AND BOLTS
- INTEGRAL LADDER ON GIN POLE SIDE
- ACCEPTS VGP-10 GIN POLE
- AVAILABLE UP TO 8 FEET HIGH IN 2 FOOT INCREMENTS



VTGS-20BH QUICK REFERENCE DATA

VTGS-20BH IS THE STANDARD MODEL NUMBER FOR VALCOM'S HEAVY DUTY STEEL HINGED TOWER. THE ANTENNA MOUNTING PLATE COMES IN FOUR DIFFERENT CONFIGURATIONS AS SHOWN BELOW. SUBSTITUTE "X" IN THE MODEL NUMBER FOR THE MOUNTING PLATE THAT IS REQUIRED. SUBSTITUTE "Y" IN THE MODEL NUMBER FOR THE HEIGHT OF TOWER REQUIRED IN 2 FOOT INCREMENTS. UNLESS OTHERWISE SPECIFIED THE STANDARD NOMINAL HEIGHT IS FOUR FEET (1.22 M)

VT GS – 20 BH – X – Y

VALCOM TOWER	GALVANIZED STEEL	EACH SIDE LENGTH	BOTTOM HINGED	MOUNTING PATTERN	TOWER HEIGHT IN FEET
-----------------	---------------------	---------------------	------------------	---------------------	----------------------------

1

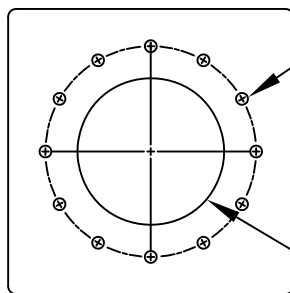

.718 IN (1.82 CM) DIA
12 HOLES EQUASPACED
ON A 14.625 IN
(37.15 CM) DIA
BOLT CIRCLE

10 IN (25.4 CM) DIA
FLAMECUT

2

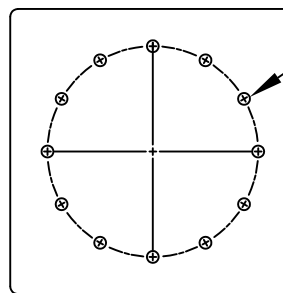

.718 IN (1.82 CM) DIA
12 HOLES EQUASPACED
ON A 14.625 IN
(37.15 CM) DIA
BOLT CIRCLE

3

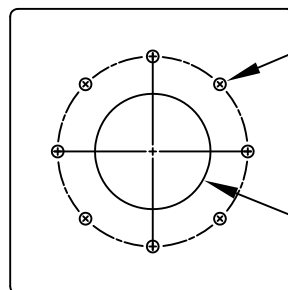

.718 IN (1.82 CM) DIA
8 HOLES EQUASPACED
ON A 10.750 IN
(27.30 CM) DIA
BOLT CIRCLE

7 IN (17.8 CM) DIA
FLAMECUT

4

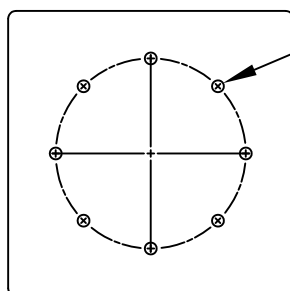

.718 IN (1.82 CM) DIA
8 HOLES EQUASPACED
ON A 10.750 IN
(27.30 CM) DIA
BOLT CIRCLE

5

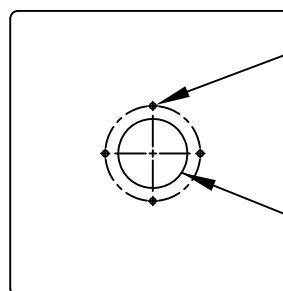

.453 IN (1.15 CM) DIA
4 HOLES EQUASPACED
ON A 5.50 IN (14.0 CM)
DIA BOLT CIRCLE

3.4 IN (8.6 CM) DIA
FLAMECUT

